



**I A R S**

**INSTANTLY ADJUSTABLE RACK SYSTEM**

**| STORAGE**





Unlike standard fixed-height storage racks, the IARS incorporates completely removable steel pallets that allow for variable shelving configurations.

These pallets can be instantly adjusted with the use of any standard forklift truck and **maximum cubic storage capacity**.

**INSTANTLY ADJUST** the height of the pallets at 6 inch (150mm) increments when required to maximise and utilise all the available space

**RIGOROUSLY TESTED** and carefully designed for superior quality, strength and durability to ensure complete safety of all racking and pallets

**OVER 20 SYSTEM SIZES** are available as standard, with a full range of heights to cope with almost any application or building constraint

**WIDE RANGE OF ACCESSORIES** are available to fully customize any system to meet your needs with new accessory options being designed all the time.

**MEETING HIGH INDUSTRY STANDARDS** globally with all racking systems designed according to Rack Manufacturers Institute (RMI), European Federation of Materials Handling (FEM) and International Building Code (IBC) guidelines

**THE ULTIMATE IN RACK  
FLEXIBILITY & EFFICIENCY**



# MAXIMISE CUBIC STORAGE



TRADITIONAL RACKING

Vs

IARS™

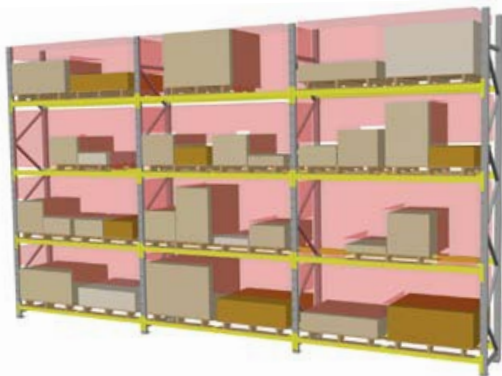

**Standard storage racks** are constructed from upright frames & platforms creating shelves of fixed height. These platforms blot or slot into position can only be adjusted by first emptying all stock from the system.

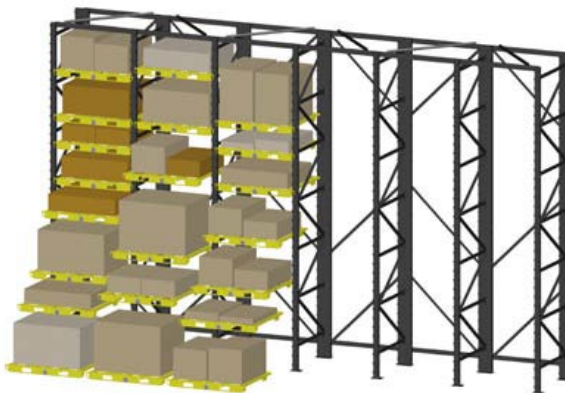

The shelves, or pallets, in **Ban-Air (IARS)** can be completely removed from their free-standing rack structure with the use of a standard forklift.

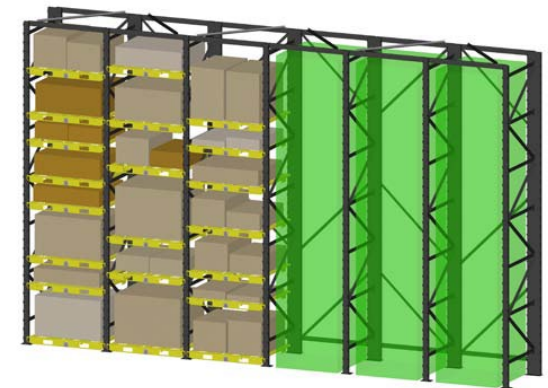

This allows for variable pallet configurations enabling you to optimize limited storage space and eliminate **wasteful storage of air**.



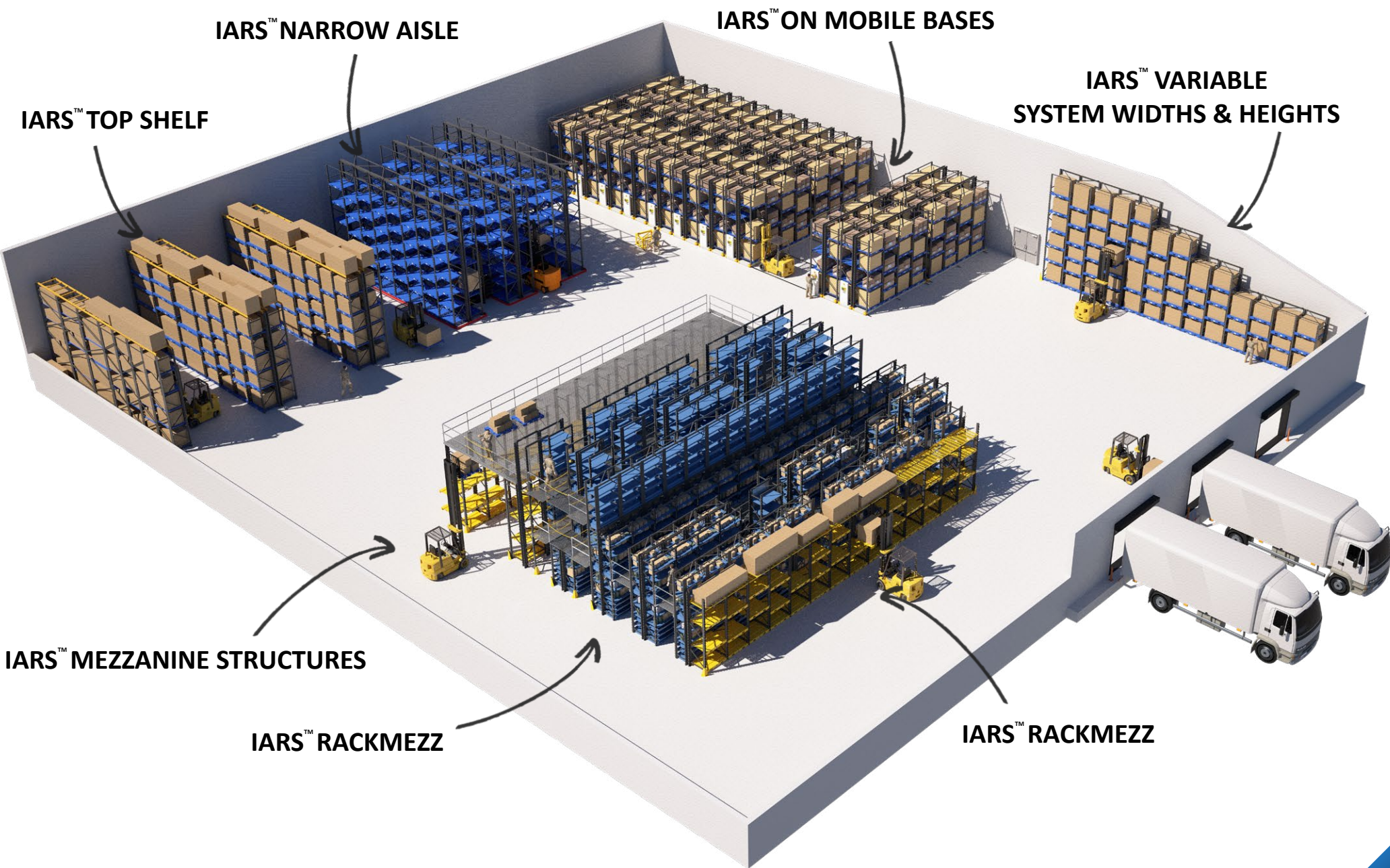

**MAKE THE MOST OF YOUR WAREHOUSE SPACE WITH BANAIR IARS**





#### IARS PALLETS

Ban-Air pallets can be positioned on 6" increments just by using a standard forklift



#### LIFETIME WARRANTY

Protecting your investment with our stamp of quality



#### DURABLE

Heavy-gauge structural steel construction with optional hot-dip galvanization for the ultimate durability



#### INSTANTLY ACCESSIBLE

Retrieve any load instantly from with the IARS rack



## IARS™ Pallet

The **BAN-AIR** pallets are at once both:  
 - **system shelves - removable pallets**  
 - **storage modules - drawer systems**  
*(when adding pallet 'add-on' accessories).*

Capacity from **1000lbs to 5000lbs**, with a range of sizes available. Pallets are either Solid Top or Flow-Thru, and can be configured as fixed Top-Shelves to create continuous shelving area for longer items.

For lightweight applications, a Light Duty Shelf is available, along with drawer systems for the smaller items.



**SYSTEM SHELVES**



**REMOVABLE PALLETS**



**STORAGE MODULES**



**DRAWER SYSTEMS**

## FOLLOW THE STEPS BELOW TO DETERMINE THE NUMBER OF PALLETS YOU REQUIRE

**1.** Identify your required load heights and using the pallet load height diagram below, note how many load points are required.

This points system accounts for the required space taken by the pallet and safe working clearances.

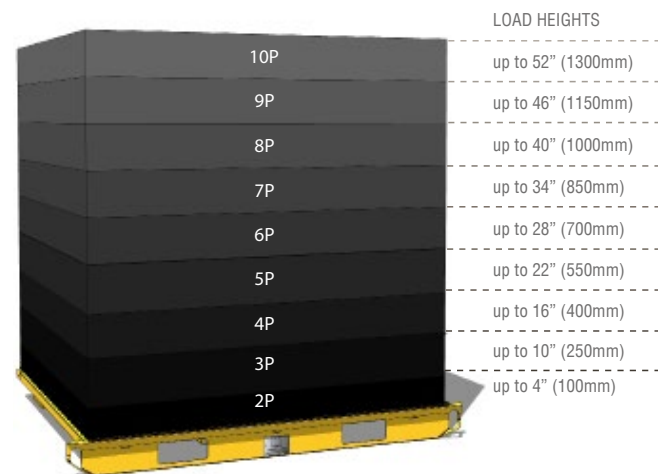

**2.** Identify how many load height points can be stored within the height of your rack using the provided

Height of Rack	Point Available
8' / 2.4m	15 P
10' / 3.0m	19 P
12' / 3.7m	23 P
14' / 4.3m	27 P
16' / 4.9m	31 P
18' / 5.5m	35 P
20' / 6.1m	39 P
22' / 6.7m	43 P
24' / 7.3m	47 P
26' / 7.9m	51 P
28' / 8.5m	55 P
30' / 9.1m	59 P

**3.** Using your combination of load heights, calculate how many pallets can be stored within one bay of rack. Multiply the number of pallets required per bay, by the number of bays within your rack to obtain the total number of pallets required.

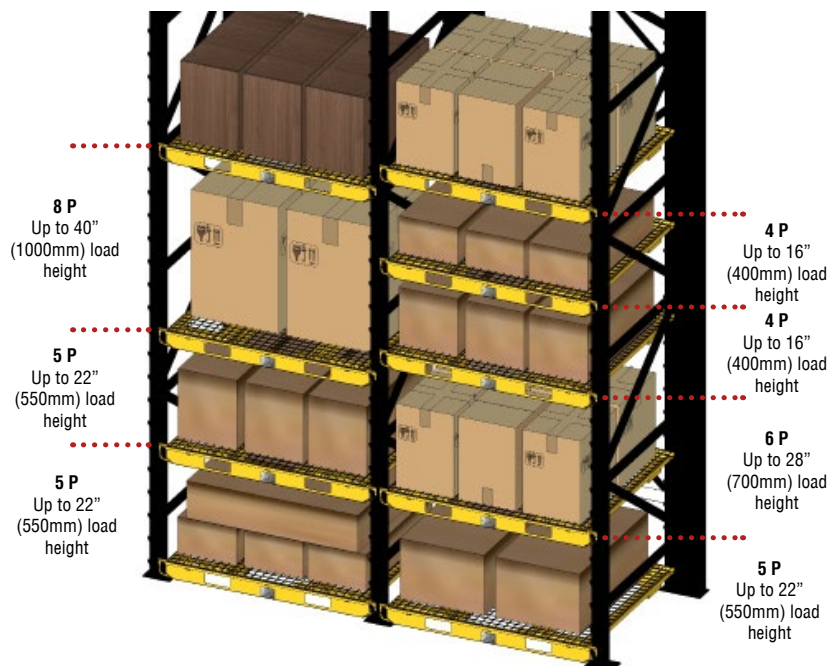

### Example

A 16' high (4677mm) rack has a total of 31P available pallet load positions

A load height of 22" / 550mm will require 5P

A load height of 40" / 1000mm will require 8P

A combination of three 5P load heights and two 8P load heights =  
 $31P (3 \times 5) + (2 \times 8) = 31$

**Based on the configuration, five pallets will be required per bay**



# IARS™ Pallet

**LIGHT-DUTY PALLET:** 500lbs (225kgs)

**FLOW-THRU PALLET:** 1000lbs - (454kgs)

2000lbs - (907kgs)

2500lbs - (1134kgs)

5000lbs - (2268kgs)

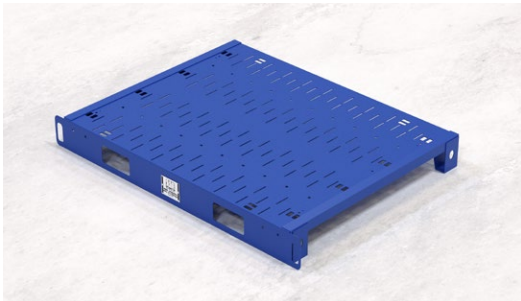

USE THIS CHART TO DETERMINE YOUR SYSTEM SIZE - Other sizes are available upon request.

- KEY**
- A. PALLET WIDTH
  - B. PALLET DEPTH
  - C. FRAME DEPTH (FRONT TO BACK)
  - D. CENTRE TO CENTRE (LEFT TO RIGHT)
  - E. FRONT COLUMN CLEARANCE (LEFT TO RIGHT)
  - F. REAR COLUMN CLEARANCE (LEFT TO RIGHT)

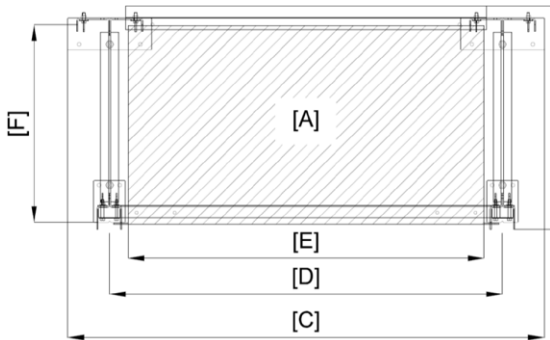

Columns					
Bay Footprint	Racking Depth	Racking Width (Starter Bay)	Racking Width (Add-on Bay)	Pallet Top Width	Pallet Top Depth
A	B	C	D	E	F
52"x30"	2'-8 1/2" (826mm)	5'-9 1/2" (1765mm)	4'-9 1/4" (1455mm)	4'-3 7/8" (1318mm)	4'-4 7/8" (732mm)
52"x42"	3'-8 1/2" (1130mm)	5'-9 1/2" (1765mm)	4'-9 1/4" (1455mm)	4'-3 7/8" (1318mm)	3'-4 3/4" (1036mm)
52"x48"	4'-8 1/2" (1279mm)	5'-9 1/2" (1765mm)	4'-9 1/4" (1455mm)	4'-3 7/8" (1318mm)	3'-10 5/8" (1185mm)
82"x42"	3'-8 1/2" (1130mm)	8'-3 5/8" (2529mm)	7'-3 3/8" (2220mm)	6'-10" (2082mm)	3'-4 3/4" (1036mm)
82"x48"	4'-2 3/8" (1279mm)	8'-3 5/8" (2529mm)	7'-3 3/8" (2220mm)	6'-10" (2082mm)	3'-10 5/8" (1185mm)

# IARS™ Rack

Rack Height	Rack Height
8ft	8'-1 3/8" (2472mm)
10ft	10'-1 3/8" (3082mm)
12ft	12'-1 3/8" (3691mm)
14ft	14'-1 3/8" (4301mm)
16ft	16'-1 3/8" (4910mm)
18ft	18'-1 3/8" (5520mm)
20ft	20'-1 3/8" (6130mm)
22ft	12'-1 3/8" (6739mm)
24ft	24'-1 3/8" (7349mm)
26ft	26'-1 3/8" (7958mm)
28ft	28'-1 3/8" (8568mm)
30ft	30'-1 3/8" (9178mm)

\*Racking dimensions before shimming

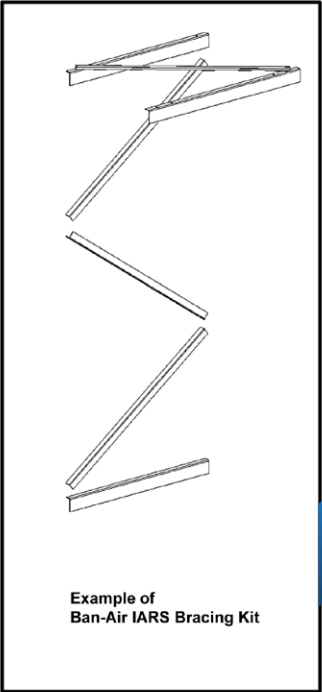
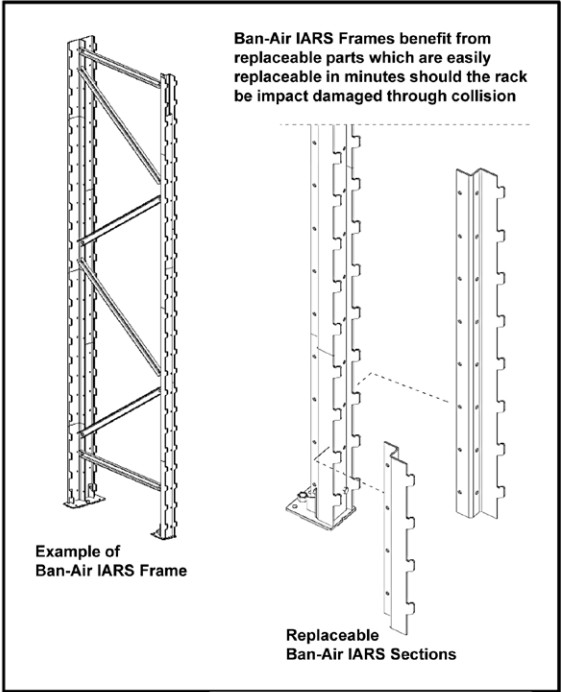
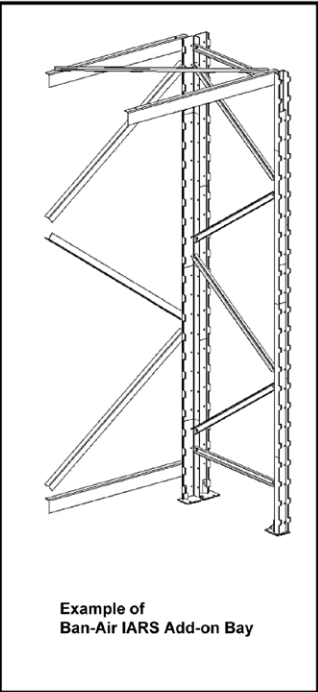
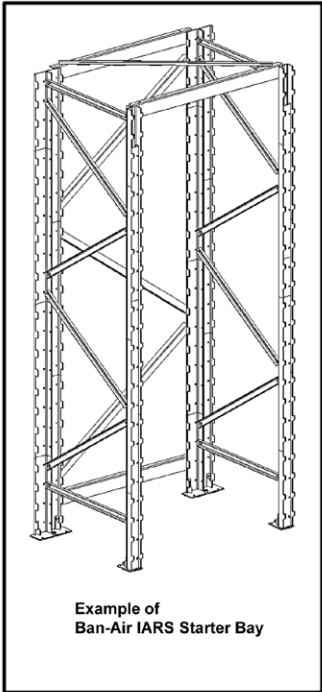



# IARS™ Accessories

## WIDE RANGE OF RACK & PALLET ACCESSORIES:

### RACK ACCESSORIES

- Guide Rails
- Safety Barriers
- Cantilever Arms
- Work Benching
- Anti-Fall Mesh
- Vertical Locator Feature
- Row/Bay Labels
- Rack Quick Repair Kits
- Walk-Thru Feature
- Additional Shim Packs & Floor Anchors

### PALLET ACCESSORIES

- Light Duty Shelves
- Load Retainers
- Partitioning Kits
- Tire Storage Modules
- HazMat Drip Trays
- Bin Module
- Security Cabinet
- Modular Basket
- Parachute Cage
- Lashing Kit
- Work-In-Progress Cart



IARS™ Mobile Bases







[www.ban-air.com](http://www.ban-air.com)

Distributed By:



**patterson•pope**

SPACE MADE **SIMPLE.**

[pattersonpope.com](http://pattersonpope.com)

866.866.4778